

Marwi item: CB-130
Standard bearing number: 6704 2RS
Dimension (mm): 20 x 27 x 4

Scale 1:1

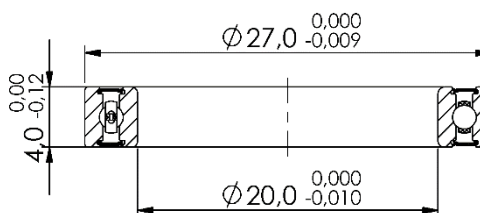

Scale 2:1



Technical specifications:

Races:	CrMo
Balls:	CrMo (HRC 61-66)
Retainer:	Steel
Sealing:	Rubber 2RS (light contact)
Grease:	Multemp SRL (Kyodo Yushi)
Tolerance:	ABEC-3
Quantity of balls:	18 pcs
Dimension of balls:	1,588mm (1/16")
Basic dynamic load rating:	1,400 kN
Basic static load rating:	0,720 kN

Applications:

Hub / wheel: Specialized Roval and various other brands